

EVENT PORTFOLIO

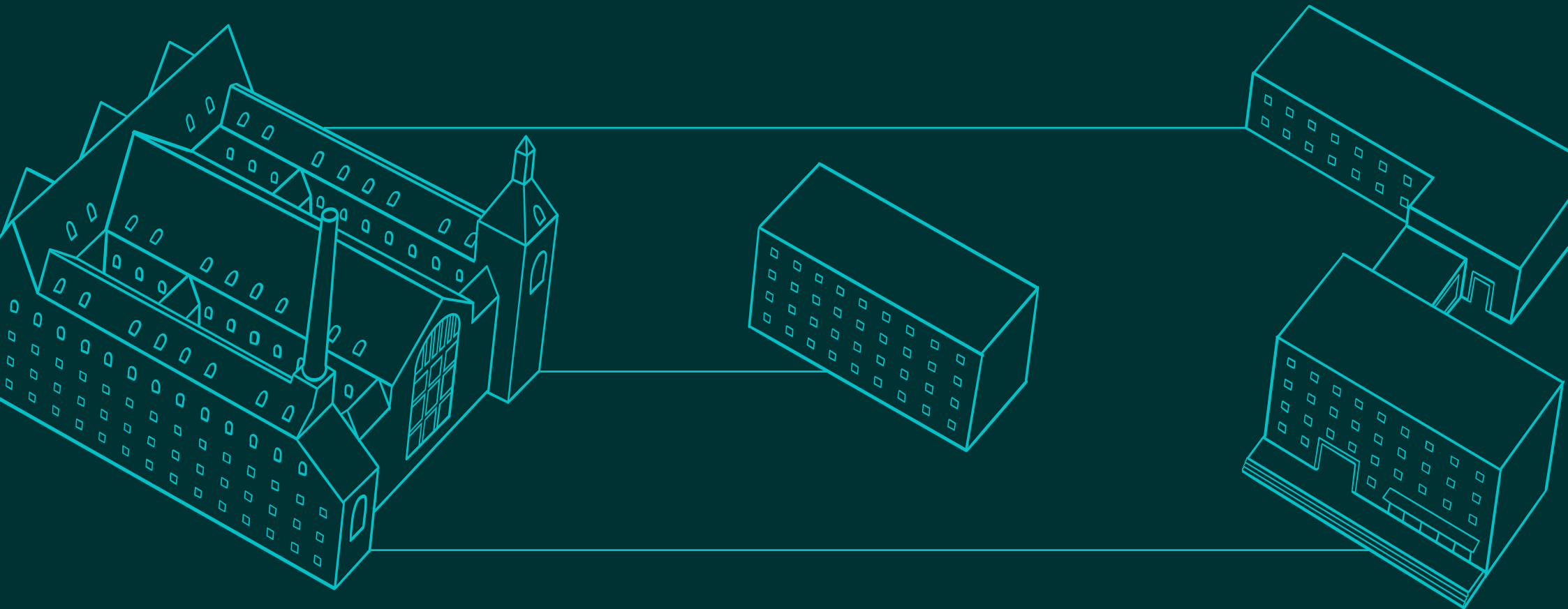

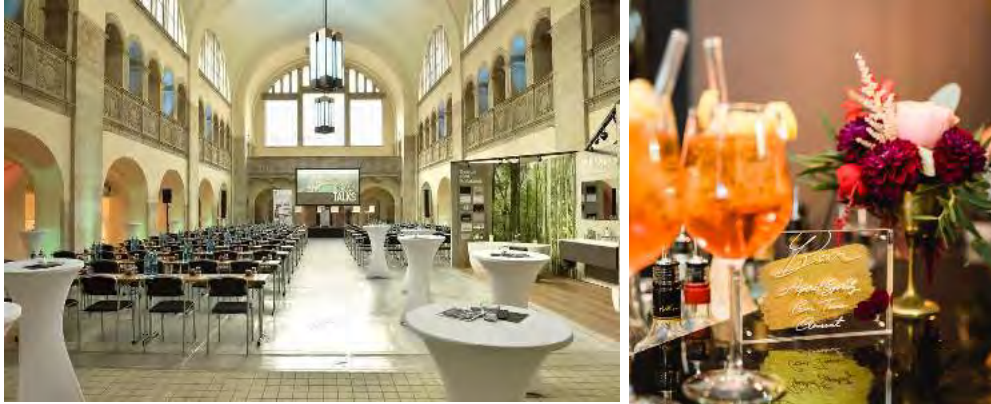

The **GLS EVENT CAMPUS BERLIN** is a unique event location at the heart of Berlin's trendy Prenzlauer Berg district. It is one of the city's most distinguished event venues.

Our campus provides everything you need: spacious seminar rooms, two hotels, the Restaurant Oderberger serving as an event location - and last but not least - our centerpiece, the pool hall in the historic Hotel Oderberger.





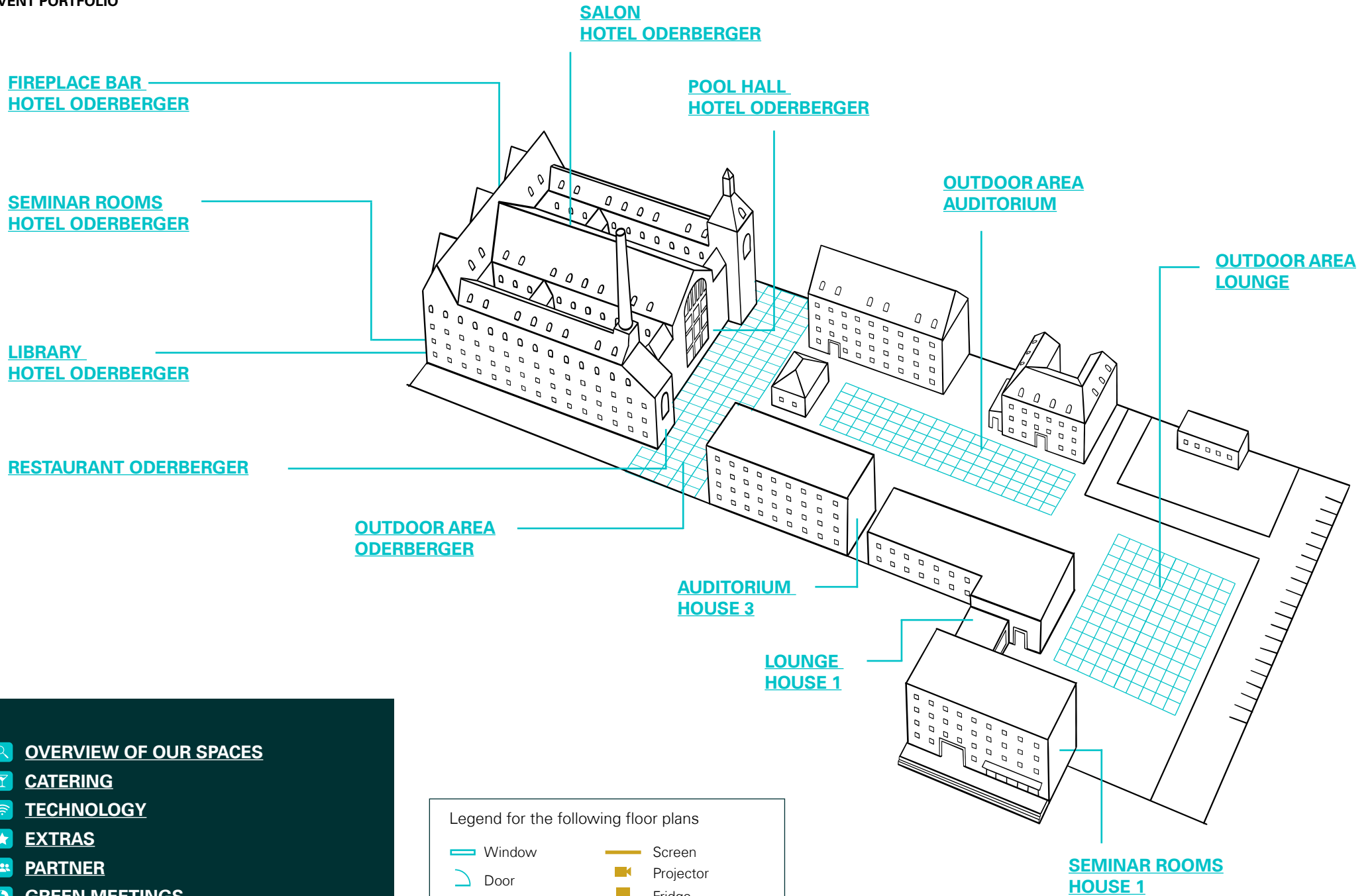

With the capacity to accommodate gatherings of various sizes – whether for 10, 50, or 600 people – the **GLS EVENT CAMPUS BERLIN, along with Hotel Oderberger**, is an attractive choice for conferences, seminars, meetings, and celebrations due to its diverse convenient facilities and central location.

Catering options are available through our partners and can be tailored to your preferences.









Equipped with cutting-edge event technology, the **GLS EVENT CAMPUS BERLIN** offers customizable offerings to suit your needs, including the implementation of hybrid or digital format.

[MORE ABOUT GLS](#)



-  [OVERVIEW OF OUR SPACES](#)
-  [CATERING](#)
-  [TECHNOLOGY](#)
-  [EXTRAS](#)
-  [PARTNER](#)
-  [GREEN MEETINGS](#)
-  [TERMS & CONDITIONS](#)

Legend for the following floor plans

| | |
|--|--|
|  Window |  Screen |
|  Door |  Projector |
|  Outdoor Area |  Fridge |
|  Not included |  Catering area |
| |  Stairs |



ROOM SIZE

NUMBER OF PAX DEPENDING ON SEATING

ROOM RENTAL

HIGH SEASON **LOW SEASON**
MAY-JUN+SEP-NOV

| ROOM SIZE | NUMBER OF PAX DEPENDING ON SEATING | HIGH SEASON MAY-JUN+SEP-NOV | LOW SEASON |
|---|--------------------------------------|--------------------------------|------------|
| CLASSROOMS 30m ² available on weekends only | 20 30 - - - - | 400,00€ | 250,00€ |
| ROOM 111 39m ² | 20 30 25 16 18 - | 500,00€ | 350,00€ |
| ROOM 123/129 48m ² | 22 35 30 22 24 - | 600,00€ | 450,00€ |
| ROOM 121 54m ² | 30 45 40 24 26 - | 700,00€ | 500,00€ |
| ROOM 112 63m ² | 45 50 45 30 34 - | 800,00€ | 550,00€ |
| LOUNGE 107m ² | 70 100 60 50 50 60 | 1.400,00€ | 950,00€ |
| AUDITORIUM 165m ² | 120 210 100 50 60 120 | 2.100,00€ | 1.500,00€ |
| ROOM 611/612 20m ² | - 22 15 - 8 - | 400,00€ | 250,00€ |
| SALON 60m ² | - 30 25 - 8 - | 750,00€ | 550,00€ |
| FIREPLACE BAR 60m ² available until 4 pm only | - 40 - - - - | 750,00€ | 550,00€ |
| LIBRARY 60m ² | 40 50 35 24 24 30 | 1.000,00€ | 700,00€ |
| RESTAURANT 225m ² | - - - - 150 - | from 900,00€ | |
| POOL HALL 483m ² | 180 300 - - 200 290 | 9.950,00€ | 6.950,00€ |

20%

off room hire - Discount code "**SmartMeetings**"
For bookings on Mondays or Fridays, as well as events lasting several days on weekdays

50%

off room hire - Discount code "**LateMeetings**"
For bookings of meetings, conferences, lectures, etc. from 6 pm. on

HOUSE 1 SEMINAR ROOMS

Our five workshop rooms provide ample space for the free development of ideas and creative work. Additional rooms are available for booking on weekends.

2. FLOOR

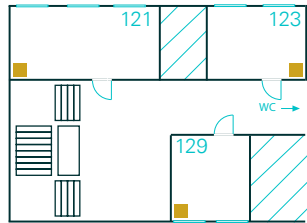

1. FLOOR

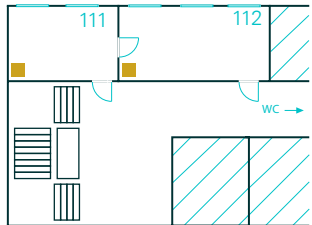

ROOM SIZE

NUMBER OF PAX DEPENDING ON SEATING

ROOM HIRE

HIGH SEASON **LOW SEASON**
MAY-JUN+SEP-NOV

| ROOM | ROOM SIZE | SEATING 1 | SEATING 2 | SEATING 3 | SEATING 4 | SEATING 5 | SEATING 6 | SEATING 7 | HIGH SEASON MAY-JUN+SEP-NOV | LOW SEASON |
|------------|--|-----------|-----------|-----------|-----------|-----------|-----------|-----------|--------------------------------|------------|
| ROOM 111 | 39m ² 6,7 x 5,8m | 20 | 30 | 25 | 16 | 18 | - | - | 500,00€ | 350,00€ |
| ROOM 123 | 47m ² 8 x 5,8m | 22 | 35 | 30 | 22 | 24 | - | - | 600,00€ | 450,00€ |
| ROOM 129 | 48m ² 8,1 x 8,8m | 22 | 35 | 30 | 22 | 24 | - | - | 600,00€ | 450,00€ |
| ROOM 121 | 54m ² 9,1 x 5,8m | 30 | 45 | 40 | 24 | 26 | - | - | 700,00€ | 500,00€ |
| ROOM 112 | 63m ² 6 x 10,5m | 45 | 50 | 45 | 30 | 34 | - | - | 800,00€ | 550,00€ |
| CLASSROOMS | 30m ² available on weekends only | 20 | 30 | - | - | - | - | - | 400,00€ | 250,00€ |

INCLUDED IN ROOM HIRE

Whiteboard
(incl. marker and magnets)
Fixed flipchart
Fixed pin boards
Pens and notepads
Smartboard

HOUSE 1

LOUNGE

The lounge is centrally located as a link between house 1 and 2, and the adjoining terrace is conveniently covered for use even during rainy weather.

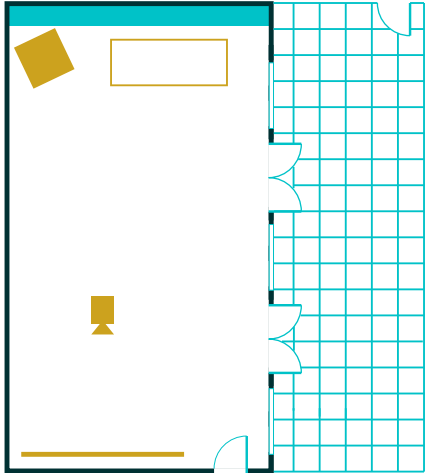

ROOM SIZE

LOUNGE 107m² **17 x 6,1 x 3,2m**

NUMBER OF PAX DEPENDING ON SEATING

70 120 60 50 55 60

ROOM HIRE

HIGH SEASON **LOW SEASON**
MAY-JUN+SEP-NOV

1.400,00€ 950,00€

FOYER/LOBBY

Catering area
Exhibition space

INCLUDED IN ROOM HIRE

Pens and notepads
Projector (ceiling installation)
Direct access to the outdoor area

HOUSE 3

AUDITORIUM

The auditorium, initially constructed as a sports hall, features sporty, classic herringbone parquet flooring and soaring 5-meter-high ceilings. Its tranquil atmosphere is complemented by the covered outdoor area and adjacent foyer, perfect for catering, adding to the auditorium's unique charm.

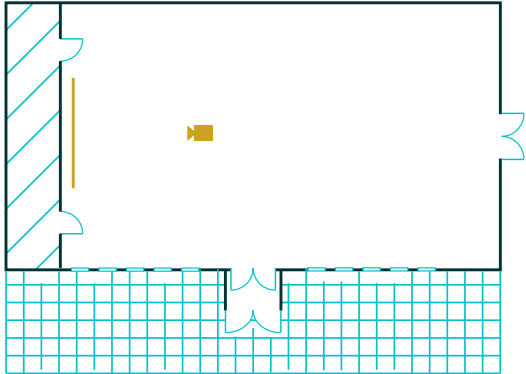

ROOM SIZE

AUDITORIUM 165m² **17 x 9,5 x 5,1m**

NUMBER OF PAX DEPENDING ON SEATING

120 220 100 50 60 120

ROOM HIRE

HIGH SEASON **LOW SEASON**
MAY-JUN+SEP-NOV

2.100,00€ 1.500,00€

INCLUDED IN ROOM HIRE

Pens and notepads
Projector (ceiling installation)
Direct access to the outdoor area

OUTDOOR AREAS

-  LOUNGE
-  AUDITORIUM
-  ODERBERGER

Consider renting one of our beautiful outdoor areas in addition to your room.

SET-UP FEE

per day

from 1.500,00€



HOTEL ODERBERGER

LIBRARY

Once a waiting area for the public baths in Prenzlauer Berg, our library now boasts a blend of historical architecture and contemporary design influences, resulting in a cozy and modern space with a unique atmosphere.



TICKET OFFICE

LIBRARY

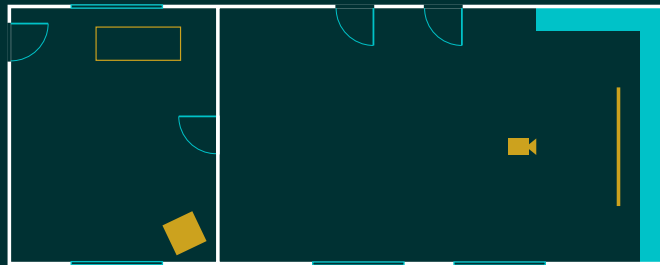

ROOM SIZE

NUMBER OF PAX DEPENDING ON SEATING

ROOM HIRE

INCLUDED IN ROOM HIRE

| | ROOM SIZE | | NUMBER OF PAX DEPENDING ON SEATING | | | | | | HIGH SEASON MAY-JUN+SEP-NOV | LOW SEASON |
|---------------|------------------|----------------|------------------------------------|----|----|----|----|----|--------------------------------|------------|
| LIBRARY | 60m ² | 10 x 5m | 40 | 50 | 35 | 24 | 24 | 30 | 1.000,00€ | 700,00€ |
| TICKET OFFICE | 24m ² | | | | | | | | | |

- Individual light setting with colour request
- Separate catering area in the ticket office
- Pens and notepads
- Projector (ceiling installation)

HOTEL ODERBERGER
SEMINAR ROOMS

Our meeting rooms at the Hotel Oderberger exude a unique historic atmosphere, characterized by their original wash cabine flair.

1. FLOOR

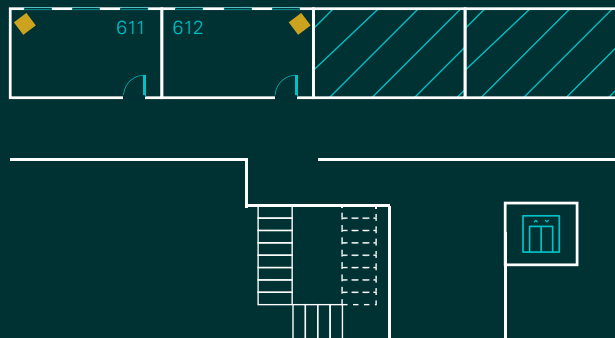

| ROOM SIZE | NUMBER OF PAX DEPENDING ON SEATING | | | | | | ROOM HIRE | |
|-----------|------------------------------------|------------|---|----|----|---|--------------------------------|------------|
| | | | | | | | HIGH SEASON MAY-JUN+SEP-NOV | LOW SEASON |
| ROOM 611 | 20m ² | 5,7 x 3,3m | - | 22 | 15 | - | 400,00€ | 250,00€ |
| ROOM 612 | 18m ² | 4,9 x 3,3m | - | 22 | 15 | - | 400,00€ | 250,00€ |

INCLUDED IN ROOM HIRE

- Whiteboard (incl. markers and magnets)
- Pens and notepads
- Smartboard

HOTEL ODERBERGER
RESTAURANT ODERBERGER

The former thermal power station of the public bath house, spread over three levels with a total room height of 15 metres and a terrace, impresses with its uniqueness. The atmosphere is a highlight for dinner evenings or lunch breaks. The integrated screen can also be booked for presentations.

SERVICE FEE LUNCH

| NUMBER OF PEOPLE | SERVICE FEE |
|------------------|-------------|
| up to 30 | 190,00€ |
| up to 50 | 290,00€ |
| from 51 | 390,00€ |

ROOM HIRE EVENTS

| | |
|----------|-----------|
| up to 50 | 900,00€ |
| from 51 | 1.500,00€ |

| SET-UP | NUMBER OF PEOPLE |
|---------------------|------------------|
| Dinner Table | 120 |
| Cocktail / Standing | 250 |

2. FLOOR

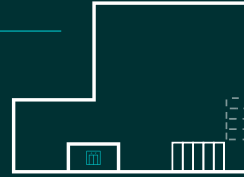

1. FLOOR

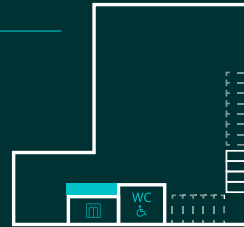

GROUND FLOOR



HOTEL ODERBERGER

FIREPLACE BAR

The Fireplace Bar (Kaminbar) captivates visitors with its elegant ambiance. Once serving as a waiting area for the Prenzlauer Berg public baths, it has transformed into a refined cocktail bar, complete with a lovely terrace that welcomes guests daily from 5 pm.

Hire the Fireplace Bar for your event daily until 4 pm.



ROOM HIRE

ROOM SIZE

NUMBER OF PAX DEPENDING ON SEATING

HIGH SEASON **LOW SEASON**
MAY-JUN+SEP-NOV

FIREPLACE BAR 60m²

-

40

-

-

-

-

750,00€

550,00€

INFO

Hire the Fireplace Bar for your event daily until 4 pm.

HOTEL ODERBERGER

SALON

The semi-open area on the upper floor of the former public baths in Prenzlauer Berg features a blend of foyer and cozy alcove. Our salon provides a balance of privacy and a central location within a sophisticated atmosphere.



1. FLOOR



ROOM SIZE

NUMBER OF PAX DEPENDING ON SEATING

ROOM HIRE

HIGH SEASON **LOW SEASON**
MAY+JUN+SEP+NOV

| | | | | | | | | | |
|-------|------------------|---|----|----|---|---|---|---------|---------|
| SALON | 60m ² | - | 30 | 25 | - | 8 | - | 750,00€ | 550,00€ |
|-------|------------------|---|----|----|---|---|---|---------|---------|

HOTEL ODERBERGER
POOL HALL

The pool hall is the heart of the Hotel Oderberger. The cathedral-like pool in neo-Renaissance style offers space for events with up to 700 people and is an extraordinary event location for galas, company celebrations, conferences, parties or concerts. The pool floor's hydraulic technology allows it to be raised, creating a unique experience where you can literally celebrate on the water!

ROOM HIRE & SET-UP

| | |
|--------------|---------------------------|
| Room hire | |
| High season | per day 9.950,00€ |
| Low season | per day 6.950,00€ |
| Set-Up fee | per Set-Up from 2.750,00€ |
| Set-Down fee | per Set-Down 2.750,00€ |
| Kitchen hire | from 700,00€ |

ADDITIONAL COSTS

| | |
|---|-------------------|
| Staff service, bar, cloak room, security, fire guard | per hour 44,50€ |
| Service manager | per hour 49,00€ |
| Event manager daily up to 10 hours | daily 500,00€ |
| | per hour 50,00€ |
| Technician daily up to 10 hours | daily 900,00€ |
| | per hour 115,00€ |
| Basic technology including detailed arrangements, set-up and dismantling, stage lighting, sound system, microphones for up to 4 speakers, lighting and staging of the architecture | per day 4.700,00€ |
| High performance projector incl. screen | per day 2.800,00€ |
| Blackout Curtain | per day 500,00€ |

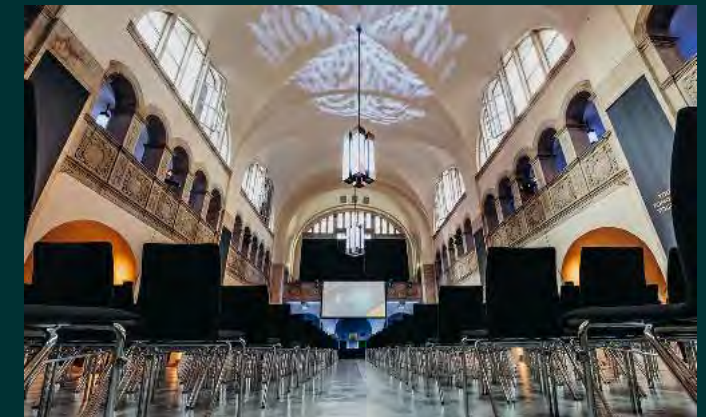
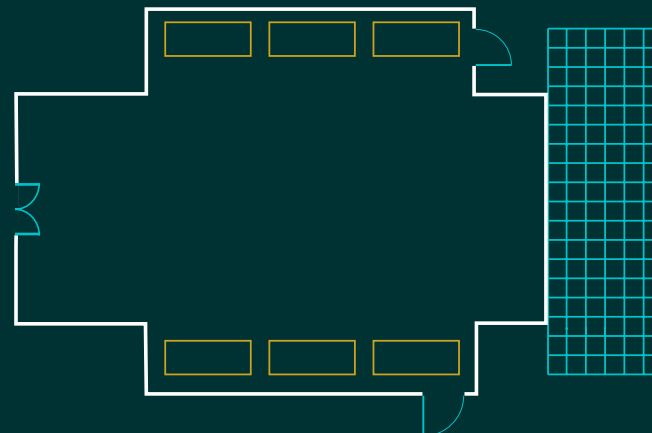

CATERING



BEVERAGE PACKAGE (ONLY AVAILABLE WITH ADVANCE BOOKING)

CONFERENCE

Kick starter package (p. P.) 5,00€

The vitalizing start into the day
1 Voelkel Ginger Shot (demeter)
1 RAW Bite Bar (organic)

Conference package (p. p.) 25,00€ / 8h

up to 8 hours

Organic juices, regional mineral water (still/sparkling), various lemonades, coffee specialties and tea from the automatic coffee machine

per hour 3,20€
available from 4 hours (12,80€)

Additional beverage set-up per seminar room (p. p.) 2,50€ / day

only when booking the conference beverage package

(Organic juices, regional mineral water (still/sparkling), coffee, tea)

Would you like your coffee (filter coffee) & tea prepared directly in the room?

Up to 24 people **20,00€ / day**
From 25 people **inclusive**

RECEPTION

Sparkling wine basic (p. p.) 6,60€ / 30min

Berlinsky sparkling wine, various juices, mineral water, draught beer

Sparkling wine plus (p. p.) 8,50€ / 30min

Buhl Riesling sparkling wine, various juices, mineral water, draught beer

Crémant (p. p.) 9,50€ / 30min

Crémant, various juices, mineral water, draught beer

Aperitif basic* (p. p.) 10,50€ / 30min

Aperol Spritz
Lillet Wild Berry
Limoncello Spritz

Non-alcoholic selection

Various juices
Veneziano Spritz
Mineral water

Aperitif plus* (p. p.) 12,50€ / 30min

Aperol Spicy Ginger
Porttonic

Non-alcoholic selection

Berry lemonade
Spritz Veneziano

*Please choose an alcoholic and a non-alcoholic variant

DINNER

Dinner package (p. p.) 9,50€ / 1h

Berlinsky sparkling wine

White wine - choose from:
Oderberger Chardonnay Q.b.A.
Winery Michel, Rheinhessen

or

Oderberger Grauburgunder, Q.b.A.
Winery Rinck, Pfalz

Red wine - choose from:
Oderberger Cuvée Noir Q.b.A.,
Winery Oliver Zeter, Pfalz

or

Oderberger Spätburgunder,
Winery Michel, Rheinhessen

Beer

Draught beer, BRLO Pale Ale, BRLO Naked (non-alcoholic), Erdinger Weizen

Soft Drinks & Mineral Water

Fritz Limos (Kola, Kola sugarfree, lemon),
Rauch Icetea (peach), Ostmost spritzer,
Organic juices, Mineral water (regional) still/sparkling

Hot Beverages

Espresso, Cappuccino, Café Creme, Café Latte, Latte Macchiato

+ Aperitif Upgrade 3,00€ / 1h

Choose 1 alcoholic and 1 non alcoholic option

alcoholic: Aperol Spritz, Lillet Wild Berry

non-alc.: Veneziano Spritz, Berry lemonade

+ Longdrink Upgrade 5,00€ / 1h

Tanqueray Gin, Three Sixty Vodka, Havana 3 Rum & Famous Grouse
Thomas Henry Ginger Ale, Bitter Lemon,
Tonic Water Spicy Ginger
incl. Aperitif Upgrade

INVOICED BY OPENED BOTTLE

Please note that our fridges are stocked with mineral water, juices and Fritz lemonades as standard. If you do not wish to offer any of these to your guests, please communicate your preferences internally. Otherwise, any opened bottles will be subject to charges.

MINERAL WATER

| | |
|---|-------|
| Regional mineral water 1,0 l (Hotel Oderberger) | 8,00€ |
| Regional mineral water 0,75 l | 7,50€ |
| Regional mineral water 0,33 l | 3,50€ |

JUICE/SOFT DRINKS

| | |
|--|--------|
| Fritz (Kola, Lemon, Sugarfree, Rhubarb) 0,33 l | 3,50€ |
| Rauch Ice tea (Peach) | 3,50€ |
| Ostmost Spritzer | 3,50€ |
| Bauer Juice 0,2 l different varieties | 3,50€ |
| Thomas Henry (Ginger Ale, Bitter Lemon, Tonic Water) 0,2 l | 3,50€ |
| Thomas Henry (Ginger Ale, Bitter Lemon, Tonic Water) 1 l | 10,00€ |

HOT BEVERAGES

Our coffee and tea range consists of 100% organic and fair trade products.

| | |
|--|--------|
| Filter coffee (10 cups) (Campus) | 35,00€ |
| Tea (8 cups) (Campus) | 16,00€ |
| hot water with an assortment of different teas | |
| Filter coffee (5 cups) (Oderberger) | 17,50€ |
| Tea (5 cups) (Oderberger) | 8,00€ |
| Coffee specialties (per cup) | 3,50€ |
| from the automatic machine in the lobby of the GLS Campus Berlin and in the lounge of the Hotel Oderberger | |

Would you like your coffee (filter coffee) prepared directly in the room? Up to 24 persons. From 25 persons free of charge 20,00€ / day

BEER

| | |
|---|-------|
| Draught beer 0,3l | 4,00€ |
| BRLO Pale Ale (bottled) 0,33l | 4,00€ |
| Heineken (bottled) 0,33l | 4,00€ |
| Erdinger Weizen (bottled) 0,5l | 4,50€ |
| Störtebeker FreiBier (non alcoholic, bottled) | 4,00€ |

APERITIF

| | | | |
|----------------------|--------|----------------------|-------|
| Aperol Spritz | 8,50€ | non-alcoholic | |
| Limoncello Spritz | 8,50€ | Berry lemonade | 6,00€ |
| Lillet Wild Berry | 8,50€ | Veneziano Spritz | 8,50€ |
| Aperol Spicy Ginger | 9,50€ | | |
| Raspberry Basil Mule | 10,00€ | | |

SPARKLING WINE

| | |
|--|---------|
| Berlinsky 0,1l | 5,00€ |
| Buhl Riesling 0,1l | 6,00€ |
| Berlinsky 0,75l | 35,00€ |
| Buhl Riesling 0,75l | 42,00€ |
| Pinot Rose „Oderberger Gold Edition“ 0,75l | 42,00€ |
| Ruinard Blanc de Blancs 0,75l | 120,00€ |

WHITE WINE

| | |
|---|--------|
| Oderberger Chardonnay Q.b.A. 0,75l | 28,00€ |
| Exclusive bottling from Winery Michel, Rheinhessen | |
| Dry, soft elegant body, pleasant fruity-mineral freshness | |

| | |
|--|--------|
| Oderberger Grauburgunder. 0,75l | 28,00€ |
| Exclusive bottling from Winery Rinck, Pfalz | |
| dry, classic Pinot Gris with a pure nose with citrus notes, nutty nuances and a hint of herbal spice. Pleasantly fresh and well-structured on the palate | |

| | |
|---------------------------------------|--------|
| Sauvignon Blanc 0,75l | 34,00€ |
| Winery Knewitz Appenheim, Rheinhessen | |
| dry, slightly fruity & vegetal aromas | |

| | |
|---------------------------------|--------|
| Riesling Q.b.A. 0,75l | 37,00€ |
| Winery Robert Weil, Rheinhessen | |
| dry, mineral, fruity, elegant | |

RED WINE

| | |
|--|--------|
| Oderberger Cuvée 0,75l | 29,00€ |
| Winery Zeter, Pfalz, dry, cuvée made from Pinot Noir, Cabernet Sauvignon, Merlot, St. Laurent, intense aromas of cherry, wild berries and elegant spicy notes. The body is multi-faceted, clearly structured, with a ripe tannin | |

| | |
|---|--------|
| Oderberger Spätburgunder 0,75l | 29,00€ |
| Exclusive bottling from Winery Michel, Rheinhessen dry, classic Pinot Gris with a pure nose with citrus notes, nutty nuances and a hint of herbal spice. Pleasantly fresh and well-structured on the palate | |

| | |
|---|--------|
| Incognito (vegan) Winery Phillip Kuhn, Pfalz 0,75l | 38,00€ |
| dry / 15 months ageing in older French oak barriques results in a medium-bodied red wine with wonderful fruit accents | |

ROSÉ WINE

| | |
|---|--------|
| Rotling Q.b.A. Winery Max Müller, Franken | 29,00€ |
| dry / animating wine, reminiscent of fruits such as redcurrants and cherries. This wine is a great pleasure to drink with food or as a soloist. | |

GIN TONIC

| | |
|-------------------------------------|--------|
| Tanqueray & Thomas Henry Tonic | 8,50€ |
| Hendrick's Gin & Thomas Henry Tonic | 9,50€ |
| Ferdinand's Gin & Fever Tree Tonic | 13,00€ |

MOSCOW MULE

| | |
|---|--------|
| Three Sixty & Thomas Henry Spicy Ginger | 8,50€ |
| Stolichnaya & Thomas Henry Spicy Ginger | 9,50€ |
| Belvedere & Thomas Henry Spicy Ginger | 12,00€ |

RUM KOLA*

| | |
|--|--------|
| Havanna 3 & Fritz Kola | 8,50€ |
| Rum Kola* Havanna 7 & Fritz Kola | 9,50€ |
| Botucal Reserva Exclusiva & Fritz Kola | 11,00€ |

WHISKEY KOLA*

| | |
|------------------------------|--------|
| Famous Grouse & Fritz Kola | 8,50€ |
| Bulleit Bourbon & Fritz Kola | 9,50€ |
| Talisker & Fritz Kola | 11,00€ |

VODKA LEMON

| | |
|---|--------|
| Three Sixty & Thomas Henry Bitter Lemon | 8,50€ |
| Stolichnaya & Thomas Henry Bitter Lemon | 9,50€ |
| Belvedere & Thomas Henry Bitter Lemon | 12,00€ |

*alternatively also possible with Coca Cola

BITTER LIKORE

| | |
|--------------|--------|
| Campari 1,0l | 80,00€ |
| Aperol 1,0l | 80,00€ |

VODKA

| | |
|------------------|---------|
| Three Sixty 1,0l | 100,00€ |
| Stolichnaya 0,7l | 120,00€ |
| Grey Goose 0,7l | 150,00€ |
| Belvedere 0,7l | 180,00€ |

GIN

| | |
|----------------------|---------|
| Tanqueray 1,0l | 100,00€ |
| Ferdinand's Gin 0,7l | 150,00€ |
| Monkey 47 0,5l | 160,00€ |
| Hendricks Gin 0,7l | 190,00€ |

RUM

| | |
|--------------------------------|---------|
| Brugal Anejo 0,7l | 80,00€ |
| Havanna 3 1,0l | 100,00€ |
| Ron Pampeo Blanco 1,0l | 105,00€ |
| Havanna 7 0,7l | 130,00€ |
| Botucal Reserva Exclusiva 0,7l | 155,00€ |

WHISKEY

| | |
|----------------------|---------|
| Famouse Grouse 0,7l | 100,00€ |
| Bulleit Bourbon 0,7l | 116,00€ |
| Talisker 0,7l | 182,00€ |
| Lagavulin 0,7l | 267,00€ |

CONFERENCE FOOD (ONLY AVAILABLE ON ADVANCE ORDER)



Partners for
larger groups

UP TO 30 PEOPLE

Aveato Catering

Sandwiches & Fruit Basket (p.p.)* 11,90€

lightly filling 200-250g p. p.

2 pieces (different) per person | e.g. beetroot & mozzarella, hummus & lentil | colourful fruit basket | vegetarian and vegan

Sweet Break & Fruit Basket (p. p.)* 7,50€

snack 100-150g p. p.

sweet finger food | e.g. tray bakes, mini croissants, brownies | colourful fruit basket | vegetarian and vegan

Snack Lunch (p. p.)* 21,00€

filling 400-450g p. p.

Soup | savoury sandwiches | dessert | e.g. lentil pot, apple-pumpkin soup, cream of potato soup with bread / bread roll selection and dessert in a glass | vegetarian and vegan

UP TO 30 PEOPLE

Aveato Catering

Bowls (p. p.)* 19,00€

filling 400-450g p. P.

50% rice bowl with planted chicken | 50% quinoa bowl with sweet potatoes | Vegetarian and vegan

Snack Buffet (p. p.)* 22,00€

filling 300-350g p. p.

Curry sausage with bread (also vegan) | savoury finger food selection in street food style and a sweet dessert | e.g. quiche, chilli sin carne, roasted tartare

Grab & Eat Buffet (p. p.)* 13,00€

filling 300-350g p. p.

Selection of savoury finger food and filled bread & rolls | e.g. mini tartelette, mini gratin, filled pretzel rolls, vegetable ball platter

*Minimum order value 100,00€ incl VAT

FROM 31 PEOPLE

Gans & Gar Catering

Meeting Package 1 (p. p.) 52,00€**

Lunch buffet with salad, dessert and 2 main courses | 1 break (morning/afternoon)

Meeting Package 2 (p. p.) 59,50€**

Lunch buffet with salad, dessert and 2 main courses | 2 breaks (morning and afternoon)

Breakfast (p. p.) 22,90€

Baked:

Pretzel confectionery with topping | small filled wholemeal rolls | oven-fresh pastries

Warm In A Glas:

e.g. egg, bacon, toast cubes & baked beans or pancakes, marinated berries & maple syrup

Fruity:

Sliced fruit | healthy smoothies | overnight oats, apple puree, dried fruit & nuts

**Lunch at Restaurant Oderberger (subject to availability) at an additional cost of €190.00-390.00 depending on group size | 50% vegetarian / 50% non-vegetarian - vegan also possible on request | incl. set-up | incl. cutlery and crockery



TECHNOLOGY

INDIVIDUAL SERVICES

| | |
|---|--|
| Smartboard Bookable in all seminar rooms subject to availability (partly included in room hire) | 125,00€ item / day |
| Laptop | 170,00€ item / day |
| Laptop speaker | 20,00€ item / day |
| PA system Auditorium incl. one microphone (cordless); instruction, technical support optionally bookable | 630,00€ item / day |
| PA system Lounge/Library incl. one microphone (cordless); instruction, technical support optionally bookable | 550,00€ item / day |
| Microphone cordless (incl. tripod) | 70,00€ item / day |
| Headset | 80,00€ item / day |
| Audio recording only available on pre-order; plus delivery costs | 90,00€ item / day |
| Technician (support) min. 4 hours | 115,00€ / hour 900,00€ daily (max 10 hours) |
| Logistician As an assembly and dismantling aid | 44,50€ / hour |
| Lectern | 52,00€ item / day |
| Conference Kit | 37,00€ item / day |
| Pinboard Covered with paper upon request | 27,00€ item / day |
| Flipchart incl. paper and pens in 4 colours | 27,00€ item / day |
| Stage Element 2 x 1m, 45cm high | 52,00€ item / day |

INTERNET

Network: GLS-EVENT
Password: event29netzwerk

INTERNET

| | |
|---|---------|
| up to 20Mbit/s Bandwidth of up to 20 Mbit/s (download and upload) | free |
| <hr/> Simultaneous bandwidth (upload/download) User-identified WLAN name Own VLAN (no third-party devices in the network, secured bandwidth) | |
| up to 50Mbit/s (Upload 12,5Mbits/s) | 200,00€ |
| up to 100Mbit/s (Upload 25Mbits/s) | 300,00€ |
| up to 200Mbit/s (Upload 50Mbits/s) | 500,00€ |
| LAN connection | 150,00€ |

EXTRAS

DINNER TABLE

| | |
|---|-------|
| Table number holder (p. piece) incl. number | 4,50€ |
| Menu card (p. piece – from 50 pieces) | |
| » Standard (Hotel Oderberger Layout) | 2,50€ |
| » with individual layout | 3,50€ |
| Chair Cover (p. piece) | 8,50€ |

DRINKS

| | |
|---|---------|
| Bathtub (p. item) incl. ice, plus drinks | 90,00€ |
| Mobile Bar For tastings (gin, beer, wine, lemonade...) or simply as an atmospheric highlight | 500,00€ |

ENTERTAINMENT

| | |
|---|-----------|
| Photobooth at Hotel Oderberger | 1.050,00€ |
| Photobooth Transport (if requested) | 120,00€ |
| Fire Bowl (p. item) inkl. wood | 50,00€ |
| Gobo (p. item) Your logo on the ceiling / house wall or on the path. We will have a customised light template made for you, which you can also take with you after the event | 280,00€ |

INFO

| | |
|---|--------|
| Signage (p. way) up to 5 signs Indoors and outdoors as signposts for your guests incl. customised logo and name of the event | 50,00€ |
| Signage (p. room) 1 sign directly on the room door with the name of the workshop or room according to your programme | 10,00€ |



PARTNER

We do not directly provide certain services; instead, we collaborate with fantastic partners who put their heart and soul into looking after you and your guests. They know our premises, our team and have evolved into trusted colleagues over time.

- » Support in planning & quotation preparation
- » Creative ideas for a unique event
- » with personality and style

SPEISEN CATERING

The use of our **kitchen areas** is charged €700.00 per day/kitchen for our partners. For "non" partners we charge €2,000.00 per day. No fee will be charged in cases where the use of the kitchen is unnecessary, such as when the entire catering is delivered ready-made.



GANS & GAR

✉ buero@gansundgar.de

from 30 people

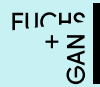

FUCHS + GANS

✉ info@fuchsundgans.com

from 70 people



AVEATO

✉ info@gls-campus-berlin.de

from 100,00 € minimum spend



DALLMAYR CATERING

✉ catering-berlin@dallmayr.de

from 10 people



WILD & WIESE

✉ anfragen@wildundwiese.de

from 30 people (dinner only)



FLORIS Catering GmbH

✉ anfrage@floris-catering.de

from 50 people



DIE HOFLIEFERANTEN

✉ anfrage@hoflieferanten.berlin

from 50 people



BERLIN CUISINE

✉ Franziska.doederlein@berlin-cuisine.com

from 100 people

TECHNOLOGY & ENTERTAINMENT

We have a wide range of in-house technology on site. For special requests or requirements, we collaborate with our partners. Please always consult our events department before making an enquiry with our partners.



LAV

✉ we@lav.events



EVENT LOBBY

✉ technik@eventlobby.de

FLOWERS



CARLA MAGNOLIA

✉ info@carlamagnolia.de



ZINNOBER

✉ we@zinnober-blumen.de



BLUMENFISCH FLORISTIK

✉ info@blumenfisch-floristik.de



Sustainability is integral to our corporate strategy, and we are committed to making meaningful contributions as both a company and a team. Our sustainability initiatives at Hotel Oderberger have been recognized with the Green Sign sustainability seal.

All detailed and further information on our sustainable events can be found in our Green Meetings document.

CATERING

According to the principles of organic, regional, seasonal and fair. Fresh products from the region protect the environment thanks to short transport routes and support the regional economy.

SOCIAL RESPONSIBILITY

The range of measures spans from noise and youth protection to equal rights and barrier-free access.

PROCUREMENT

When procuring products and services, we ensure that production and delivery are as environmentally friendly and socially responsible as possible.

COMMUNICATION

Information on sustainability measures not only raises awareness of the issue of sustainability, but also encourages imitation.

WASTE MANAGEMENT

Thanks to a well thought-out procurement and waste concept, we prevent waste from being produced in the first place. All unavoidable waste is recycled through separate disposal.

ENERGY

Factors such as building insulation, the use of green electricity, lighting, sound, media and stage technology, heating and air conditioning systems offer numerous starting points for increasing energy efficiency and saving energy.

WATER & CLEANING

Responsible use of water resources before, during and after the event.

MOBILITY

Events bring people together - but travelling to and from them and transporting goods also generates emissions. Our location is in the heart of Berlin and is very easy to reach by public transport.

LOADING AND UNLOADING FOR EVENTS

Loading and unloading for your event is always possible within the statutory times after prior consultation. As not all areas and buildings can be accessed directly by car, we are happy to provide you with flatbed lorries.

LANGUAGE COURSES FOR YOUR EMPLOYEES

We are also happy to organise foreign language courses for you - whether in-house at your company premises or on the GLS Campus. You can find information about our language courses at:

gls-sprachschule.de

STORAGE CAPACITIES

If you would like to send us materials for your event in advance, please do so promptly before your event, as we only have very limited storage capacity. Please inform us and send your parcel to the location labelled accordingly:

Veranstaltungen GLS Campus Berlin

GLS Campus Berlin,
for Mrs / Mr (your event contact at GLS)
event name + event date
Kastanienallee 82
10435 Berlin

or

Events Hotel Oderberger

Hotel Oderberger
for Mrs / Mr (your event contact at GLS)
event name + event date
Oderberger Str. 57- 59
10435 Berlin

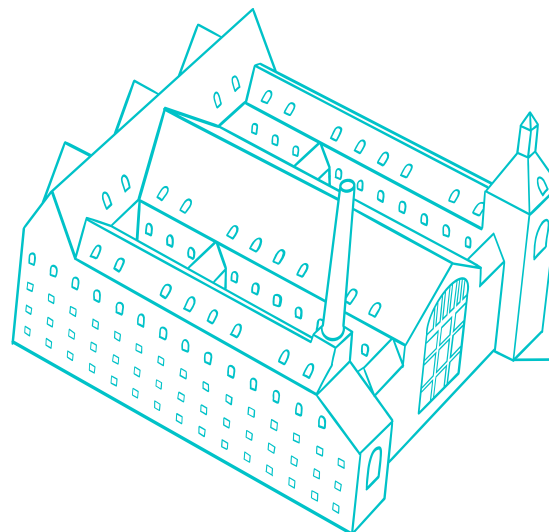

ACCOMMODATION

You are also welcome to stay overnight on campus:

Hotel Oderberger

+49 30 / 7800 89 760

info@hotel-oderberger.berlin

We are happy to recommend other hotels in our neighbourhood on request.

CAR PARKS IN THE AREA

We recommend the multistorey [car park at Kulturbrauerei](#) in Sredzkistraße, as there are very limited parking spaces available on our premises.

CAR PARK ON THE PREMISES

25.00 € per day subject to availability and prior registration including vehicle licence plate number.

Campus: Access via Choriner Straße opposite number 36, keep left on the premises.

Hotel Oderberger: Access to the left of the building, please ring the bell at the barrier and register, you will then be allocated a parking space.

Vehicles of all participants and other guests who do not have a car park registration number will be towed away for a fee.

We urgently request that you inform your participants of this. Thank you for your understanding.

TERMS AND CONDITIONS

Cancellation policy Payment terms Additional information General terms and conditions for events

For details on the above content, we have prepared Booking modalities and general terms and conditions for you - GLS Campus Berlin

VAT

All prices are gross and include the statutory value added tax.

CONTACT

GLS Event Management

Kastanienallee 82
10435 Berlin – Prenzlauer Berg

030 / 7800 89 551

info@gls-campus-berlin.de

gls-campus-berlin.de